

ROSE OFFICE SYSTEMS, INC.

Commercial Modular Buildings

(888) 608-1173 | www.RoseOffices.com

The Archer 28x60 Used Building for Lease

Available
November 2010

Exterior Specs:

- Hardipanel exterior siding
- Guttered Mansard
- 24" overhangs on endwalls
- Storefront glass front door
- Wall mounted HVACs
- EPDM rubber roof
- 36x52" windows



*Built in 2007, this building is in excellent condition!
Call today for more information!
(888) 608-1173*



Browse many more floor plans on our website at www.RoseOffices.com

The Archer 28x60 Used Building

Interior Specs:

- Five private offices
- Large open lobby
- Conference/ work area
- Break room with large storage closet
- ADA restrooms
- Solid core doors
- T-grid ceilings



The Archer 28x60 Used Building for Lease from Rose Office Systems

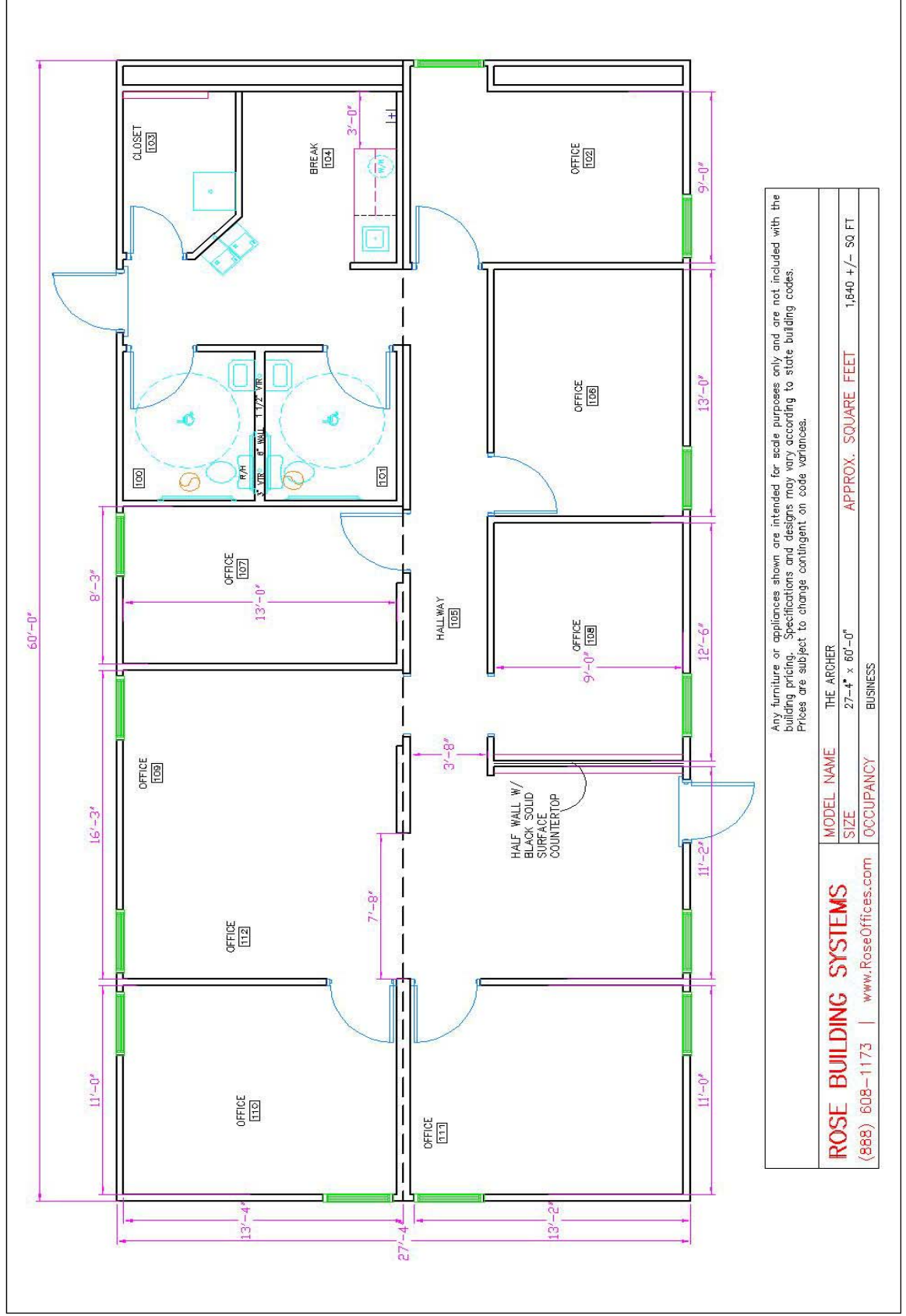

Any furniture or appliances shown are intended for scale purposes only and are not included with the building pricing. Specifications and designs may vary according to state building codes. Prices are subject to change contingent on code variances.

ROSE BUILDING SYSTEMS	MODEL NAME	THE ARCHER
(888) 608-1173 www.RoseOffices.com	SIZE	27'-4" x 60'-0"
	OCCUPANCY	BUSINESS
	APPROX. SQUARE FEET	1,640 +/- SQ. FT.