

THE ALTADENA 16' x60' CLASSROOM BUILDING (960 SQUARE FEET) ALA CODED

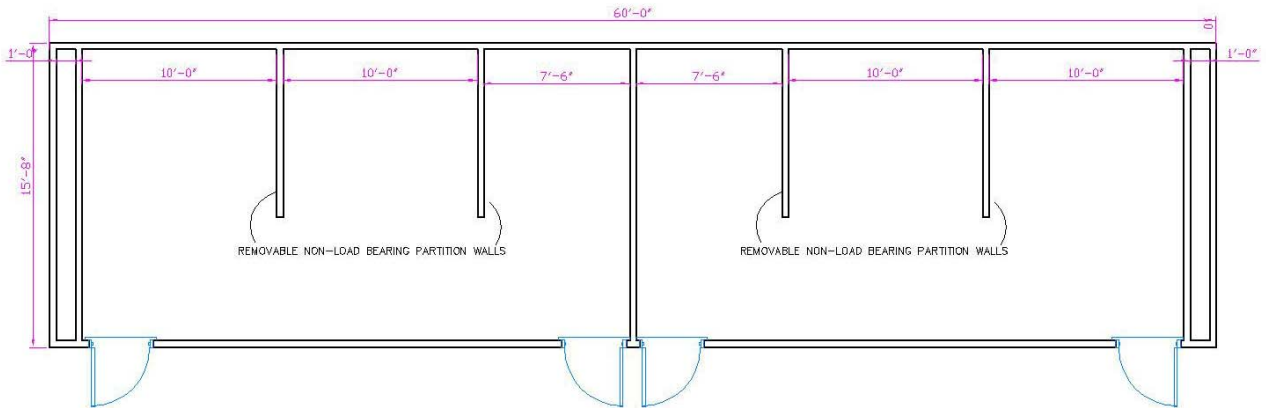

NOTE: ALL DIMENSIONS AND SIZES ARE APPROXIMATE AND MAY NOT ACCURATELY REPRESENT THE BUILDING AS SHOWN.

Any furniture or appliances shown are intended for scale purposes only and are not included with the building pricing. Specifications and designs may vary according to state building codes. Prices are subject to change contingent on code variances.

ROSE BUILDING SYSTEMS (888) 608-1173 www.RoseOffices.com	MODEL NAME	THE ALTADENA PRE-LEASED BUILDING		
	SIZE	15'-8" x 60'-0"	APPROX. SQUARE FEET	960 +/- SQ FT
	OCCUPANCY	EDUCATIONAL	STATE SEALS:	ALABAMA / GEORGIA

Specifications:

- GA / AL / MS state seals
- Educational occupancy
- Aluminum siding (beige)
- Dual HVAC systems (one per classroom)
- VCT tile floors
- Vinyl covered sheetrock walls
- Seaspray ceilings
- Surface mounted fluorescent lighting
- Removable non-load bearing partition walls included but can be removed as an option for open classroom space.

Lease pricing:

- 6-12 month lease rate: \$ 960 / month*
- 13-23 month lease rate: \$ 816 / month*
- 24-36 month lease rate: \$ 720 / month*

*Price is for monthly rental of building only. Does NOT include non-recurring items such as delivery, setup and return delivery. Those charges will be billed separately. Contact Rose Offices for more information



*Serving the Southeast
for over two decades!*

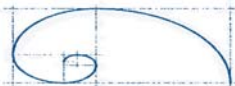

ROSE OFFICE SYSTEMS, INC.
Commercial Modular Buildings

Contact us today

(877) 767-3284 | www.RoseOffices.com | beth@roseoffices.com

(877) ROSE-BUILD